



JMI - Simavis

# JCM Series - Submersible Sewage Pump



JCM-Series Impeller  
(Enclosed Single Channel)

## JCM 50Hz

### Feature

- > Non-clog single channel impeller
- > Robust construction
- > Large solid passage
- > Dry Tip ( Option)

### Application

- > Sewage
- > Waste water

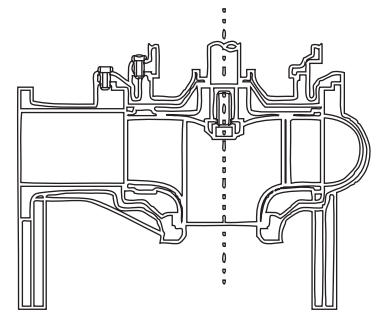
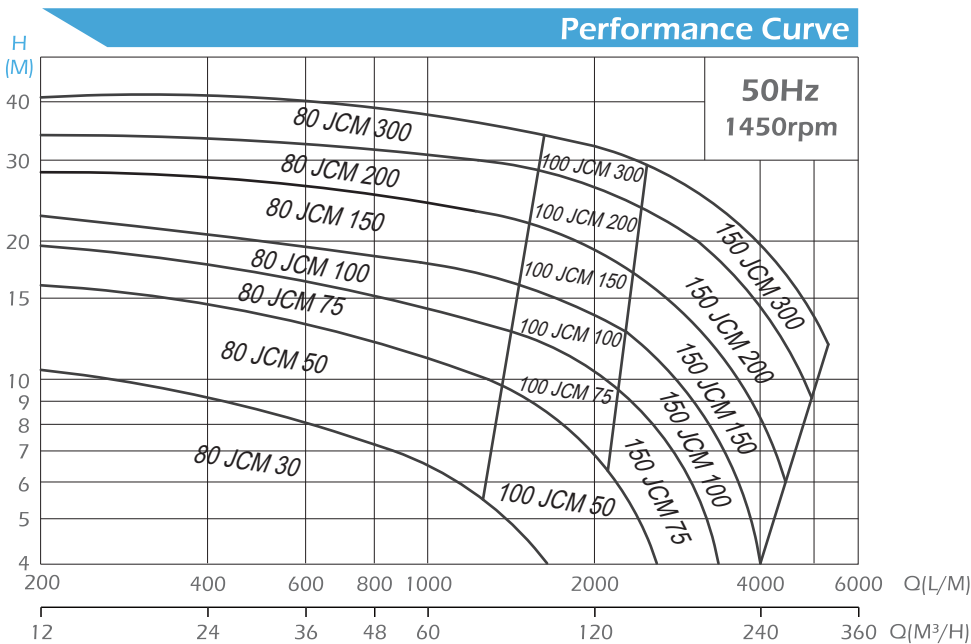

JCM 50Hz  
Impeller Type & Solids Handling

### Parts and Material List

No	Part	Mtrl
1	Submersible Cable	
2	Lifting Hanger	SS Steel
3	Thermal Protector	
4	Ball Bearing	
5	Impeller	FC-200
6	Impeller Bolt	SUS-304
7	Opposite Side Bracket	FC-200
8	Rotor	
9	Stator	
10	Shaft	SUS-403
11	Motor Frame	FC-200
12	Power Side Bracket	FC-200
13	Mechanical Seal	Upper : CA/CE Lower : SIC/SIC
14	Mechanical Seal Cover	FC-200
15	Pump Casing	FC-200

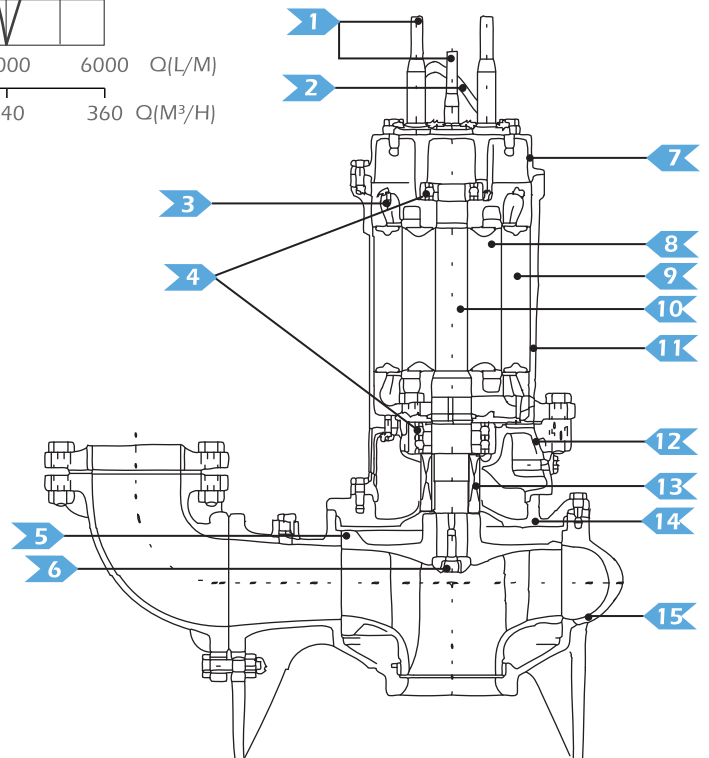

All technical information is subject to change without notice.



JMI - Simavis

# JCM Series - Submersible Sewage Pump

## Specifications

Type	Output	Discharge	Phase	Q	Max Head	Q	Rate Head	Weight
	HP	Inch	Ø	LPM	M	LPM	M	Kg
80 JCM 30	3	3"	3	200	11.2	1600	4	80
80 JCM 50	5	3"	3	200	15.8	1338	9.1	87
80 JCM 75	7.5	3"	3	300	19.3	1400	12.8	118
80 JCM 100	10	3"	3	300	22.6	1449	16	123
80 JCM 150	15	3"	3	300	28.5	1512	22.7	157
80 JCM 200	20	3"	3	300	34	1557	28.4	163
80 JCM 300	30	3"	3	300	39.5	1595	34	223
100 JCM 50	5	4"	3	1338	9.1	2407	4	89
100 JCM 75	7.5	4"	3	1400	12.8	2194	9.3	121
100 JCM 100	10	4"	3	1449	16	2270	12.6	125
100 JCM 150	15	4"	3	1512	22.7	2368	18.3	160
100 JCM 200	20	4"	3	1557	28.4	2440	23.7	166
100 JCM 300	30	4"	3	1595	34	2489	28	226
150 JCM 75	7.5	6"	3	2194	9.3	3379	4	127
150 JCM 100	10	6"	3	2270	12.6	3987	4	132
150 JCM 150	15	6"	3	2368	18.3	4472	5.5	166
150 JCM 200	20	6"	3	2440	23.7	5102	8	172
150 JCM 300	30	6"	3	2489	28	5566	10	232

## JCM Dimensions

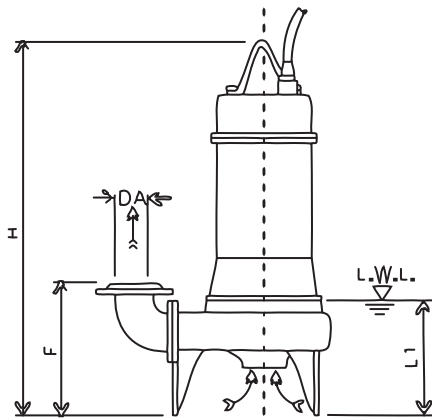

1. L.W.L.(Low Water Level) Is limited to 10 minutes operation at low water level

2. Is limited to 30minutes operation with water level below top of motor

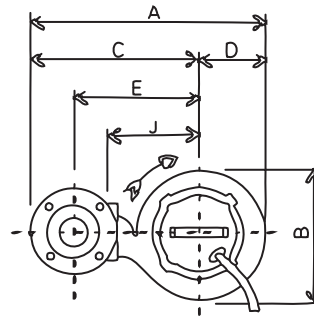

### Dimensions (mm)

Type	A	B	C	D	E	F	H	J	L1
80 JCM 30	534	320	378	157	285	298	668	210	279
80 JCM 50	534	320	378	157	285	298	727	210	279
80 JCM 75	640	381	453	188	360	334	824	255	310
80 JCM 100	640	381	453	188	360	334	824	255	310
80 JCM 150	734	455	513	221	420	350	938	315	329
80 JCM 200	734	455	513	221	420	350	938	315	329
80 JCM 300	777	497	533	245	440	363	1021	335	342
100 JCM 50	577	320	420	157	315	313	727	210	279
100 JCM 75	653	381	465	188	360	334	824	255	310
100 JCM 100	653	381	465	188	360	334	824	255	310
100 JCM 150	746	455	525	221	420	350	938	315	329
100 JCM 200	746	455	525	221	420	350	938	315	329
100 JCM 300	790	497	545	245	440	363	1021	335	342
150 JCM 75	713	381	525	188	385	369	824	255	310
150 JCM 100	713	381	525	188	385	369	824	255	310
150 JCM 150	806	455	585	221	445	385	938	315	329
150 JCM 200	806	455	585	221	445	385	938	315	329
150 JCM 300	850	497	605	245	465	398	1021	335	342